

CAD DRAWING - NO MANUAL REVISIONS

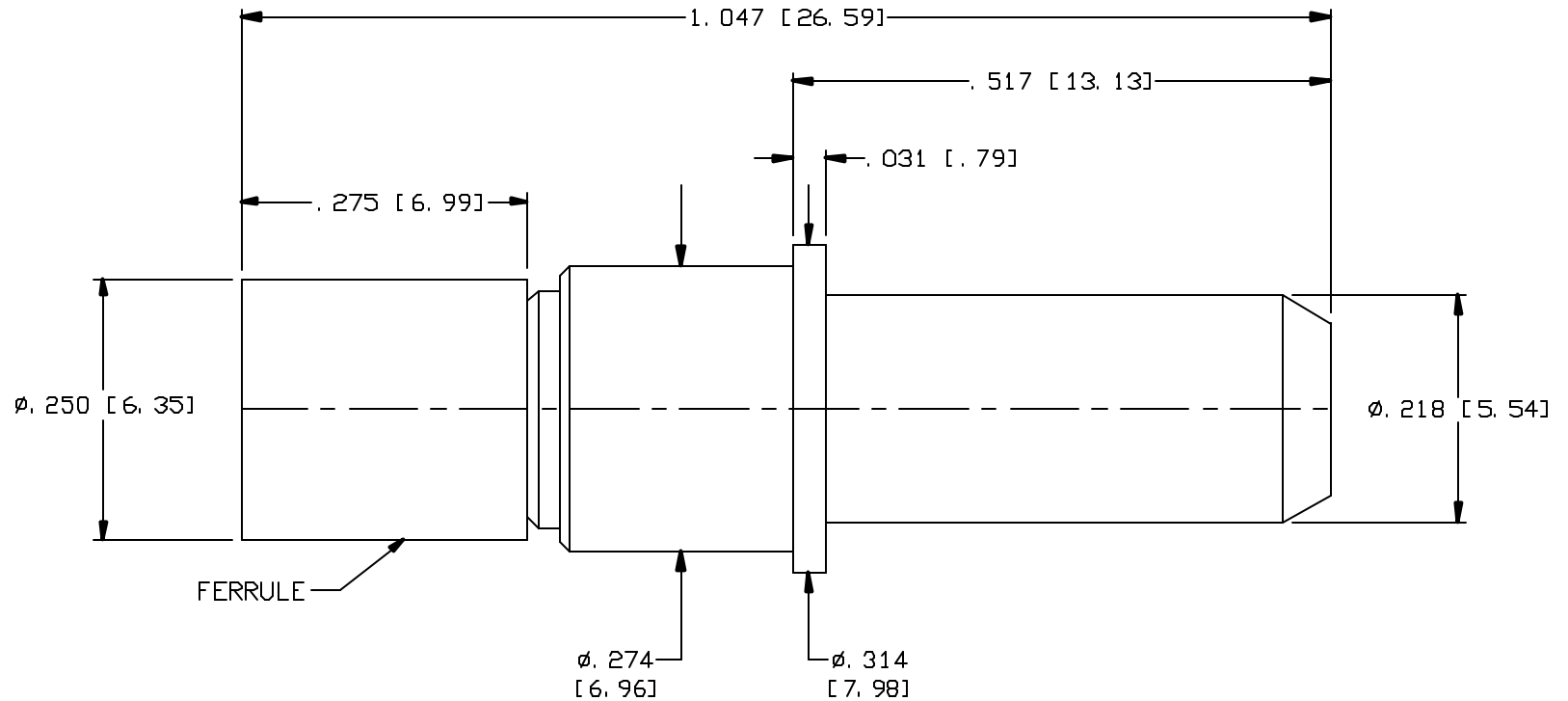

**NOTES:**

1. DESIGN AND INTERFACE PER I. D. S. -78.
2. DESIGN TO FIT MIL-C-38999, SERIES I, III & IV HOUSINGS.
3. FERRULE IS SHIPPED LOOSE.
4. ACCOMMODATES RG-142 D/S (M17/60) OR EQUIVALENT CABLES.
5. CRIMP WITH .213 HEX Y-197 DIE SET (M22520/5-05).

				<p><b>PALCO CONNECTOR</b></p> <p>22 GREAT HILL RD., NAUGATUCK, CT 06770</p> <p>UNLESS OTHERWISE SPECIFIED, PALCO WORKMANSHIP STANDARDS APPLY</p> <p>TOLERANCES ON: DECIMALS: XX ± .01 .XXX ± .005 ANGLES ±1/2° 32</p> <p>DIMENSIONS IN INCHES OR (METRIC) DO NOT SCALE PRINTS</p>	DRAWN EK	CHECKED JEM	ENGINEER EK	APPROVED JEM	FSCM 58167
B	PER ECN 11420	08/23/12	JEM			DESCRIPTION PKZ, PLUG, CRIMP TYPE			
A	PER ECN 9837	03/17/09	JEM		DATE 02/26/09	DRAWING NO. 78-0080-2201		PLATING OPT. A, B, C, D	
REV.	DESCRIPTION	DATE	APPR.		FSR # 9105;				

THE INFORMATION IN THIS DOCUMENT IS CONFIDENTIAL AND PROPRIETARY AND MAY NOT BE USED FOR ANY PURPOSE WITHOUT THE WRITTEN CONSENT OF PALCO.

CABLE ASSEMBLY PROCEDURE	
P/N	78-0080-2201
PAGE 1 OF 1	DATE: 02/26/09
DRAWN: EK	APPROVED: JEM
FOR RG-142 D/S (M17/60) CABLE	

**PALEO**  
**CONNECTOR**

22 GREAT HILL ROAD, NAUGATUCK, CT. 06770  
PHONE: (203) 729-9090 FAX: (203) 723-1794

REV	DESCRIPTION	DATE	APPR
A	PER ECN 9837	03/17/09	JEM
B	PER ECN 11420	08/23/12	JEM

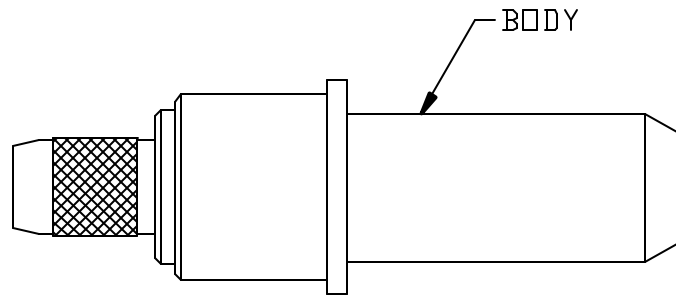
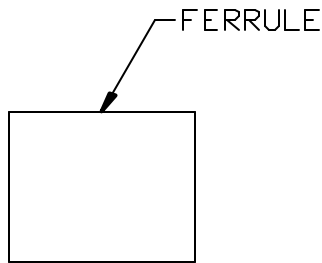

STEP 1  
TRIM CABLE TO DIMENSIONS  
SHOWN. POINT CENTER CONDUCTOR.

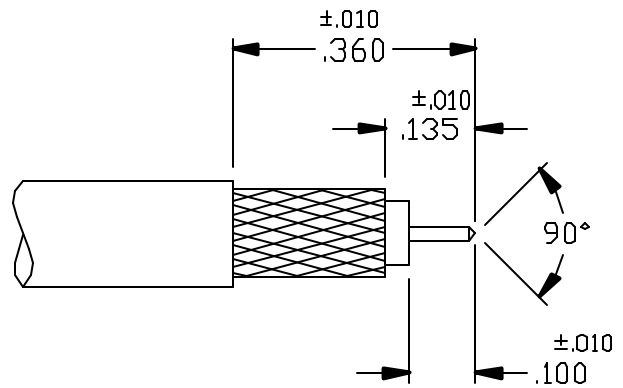

STEP 2  
SLIDE FERRULE OVER CABLE AND  
FLAIR BRAID BY ROTATING CABLE  
DIELECTRIC.

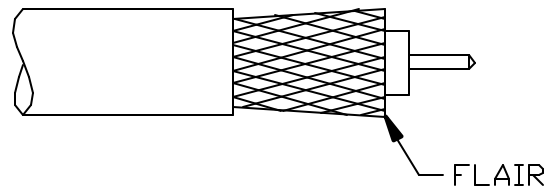

STEP 3  
SLIDE CABLE INTO BACK  
OF CONNECTOR UNTIL  
CABLE BOTTOMS. SLIDE  
FERRULE INTO POSITION  
AND CRIMP USING A .213  
HEX DIE (M22520/5-05).

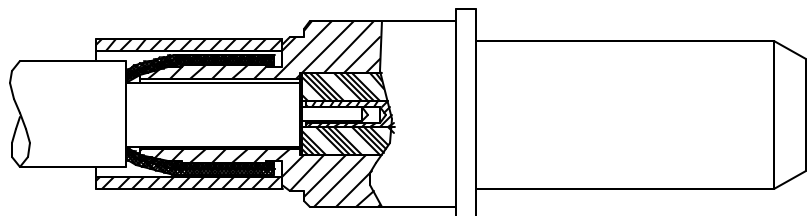

INTERFACE DESIGN STANDARD			REV	DESCRIPTION	DATE	APPR
IDS-78			B	PER ECN 5123	06/29/99	HN
PAGE 1 OF 2	DATE: 06/16/98		C	PER ECN 9935	05/22/09	JEM
DRAWN: JEM	APPROVED: HN		D	PER ECN 10145	01/20/10	JEM
		22 GREAT HILL ROAD, NAUGATUCK, CT. 06770				
		PHONE: (203) 729-9090 FAX: (203) 723-1794				

DESCRIPTION: 78 SERIES, SIZE 8 PKZ® , FOR MIL-C-38999

MECHANICAL

**MATERIALS**  
**BODIES:**  
 PLUG BODIES - BRASS PER ASTM B 16.      INSULATORS - TEFLON (PTFE) PER ASTM D 1457.  
 RECEPTACLE BODIES - BRASS PER ASTM B 16.      RETAINING RING - BERYLLIUM COPPER PER ASTM B 196.  
 MALE CONTACT - BERYLLIUM COPPER PER ASTM B 197.  
 FEMALE CONTACTS - BERYLLIUM COPPER PER ASTM B 197.  
 GROUNDING RING - BERYLLIUM COPPER PER ASTM B 196.

**PLATING:**  
 GOLD PER MIL-G-45204.  
 COPPER PER MIL-C-14550.  
 NICKEL PER QQ-N-290.

FINISHES (ADD LETTER TO END OF PART NUMBER)

"A" - .000050 MIN. GOLD OVER NICKEL  
 "B" - .000030 MIN. GOLD OVER NICKEL  
 "C" - .000050 MIN. GOLD OVER COPPER  
 "D" - .000030 MIN. GOLD OVER COPPER

MATING CHARACTERISTICS

OUTER BODIES ————— 3 LBS MAX. INSERTION.  
 2 OZ. MIN. WITHDRAWL.  
 CENTER CONTACTS ————— 32 OZ. MAX. INSERTION.  
 .5 OZ. MIN. WITHDRAWL.  
 HOUSING RETENTION ————— 12 LBS. MIN.  
 AXIAL MATING TOLERANCE — .090

ELECTRICALS

FREQUENCY RANGE: DC TO 32 GHz.  
 VOLTAGE RATING STRAIGHT: 1000 VRMS.  
 VOLTAGE RATING ANGLED: 800 VRMS.  
 CURRENT RATING: 5 AMPS.  
 INSULATION RESISTANCE: 2000 MEGOHMS MIN.  
 INSERTION LOSS: .06 √(F/GHz) dB

CONTACT RESISTANCE: CENTER CONTACT 5 MILLIOHMS  
 CONTACT RESISTANCE: OUTER CONTACT 3 MILLIOHMS  
 VSWR: 1.08 + .009(F) GHz., RG-402 CABLE.  
 1.15 + .02 (F) GHz., RG-174 & RG-316 CABLES.  
 1.15 + .01 (F) GHz., RG-142, 223, 303 & 400 CABLES.

ENVIRONMENTAL

OPERATING TEMPERATURE: -55°C to +165°C  
 VIBRATION: MIL-STD-202, METHOD 204, TEST CONDITION D.  
 SHOCK: MIL-STD-202, METHOD 213, TEST CONDITION I.  
 SALT SPRAY: MIL-STD-1344, METHOD 1001, CONDITION B.  
 DURABILITY: 500 CYCLES.

THERMAL SHOCK: MEL-STD-202, METHOD 107, TEST CONDITION B, EXCEPT HIGH TEMPERATURE SHALL BE +85°C.  
 MOISTURE RESISTANCE: MIL-STD-202, METHOD 106. NO MEASUREMENT AT HIGH HUMIDITY. INSULATION RESISTANCE 2000 MEGOHMS AFTER HUMIDITY.

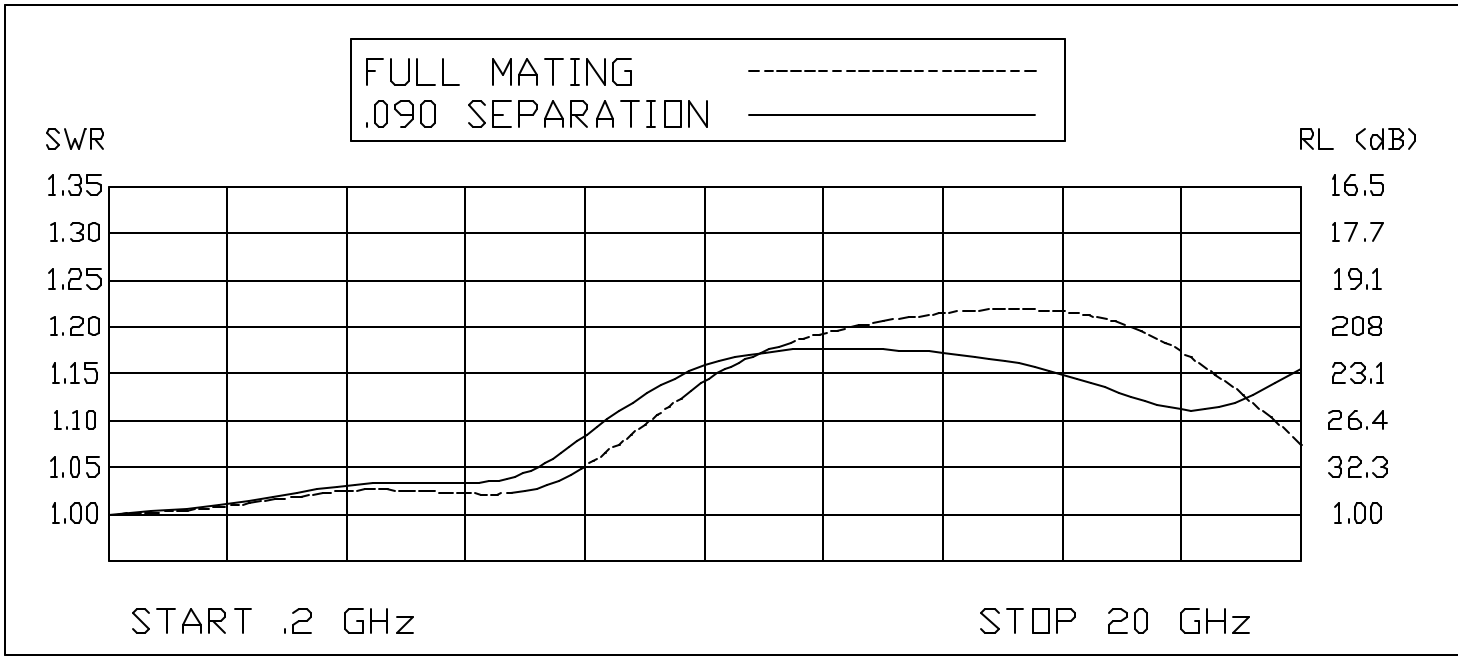

INTERFACE DESIGN STANDARD	
IDS-78	
PAGE 2 OF 2	DATE: 06/16/98
DRAWN: JEM	APPROVED: HN

**PALEO**  
**CONNECTOR**

22 GREAT HILL ROAD, NAUGATUCK, CT. 06770  
PHONE: (203) 729-9090 FAX: (203) 723-1794

REV	DESCRIPTION	DATE	APPR
B	PER ECN 5123	06/29/99	HN
C	PER ECN 9935	05/22/09	JEM
D	PER ECN 10145	01/20/10	JEM

DESCRIPTION: 78 SERIES, PKZ<sup>®</sup> SIZE 8, FOR MIL-C-38999

