

CAD DRAWING - NO MANUAL REVISIONS

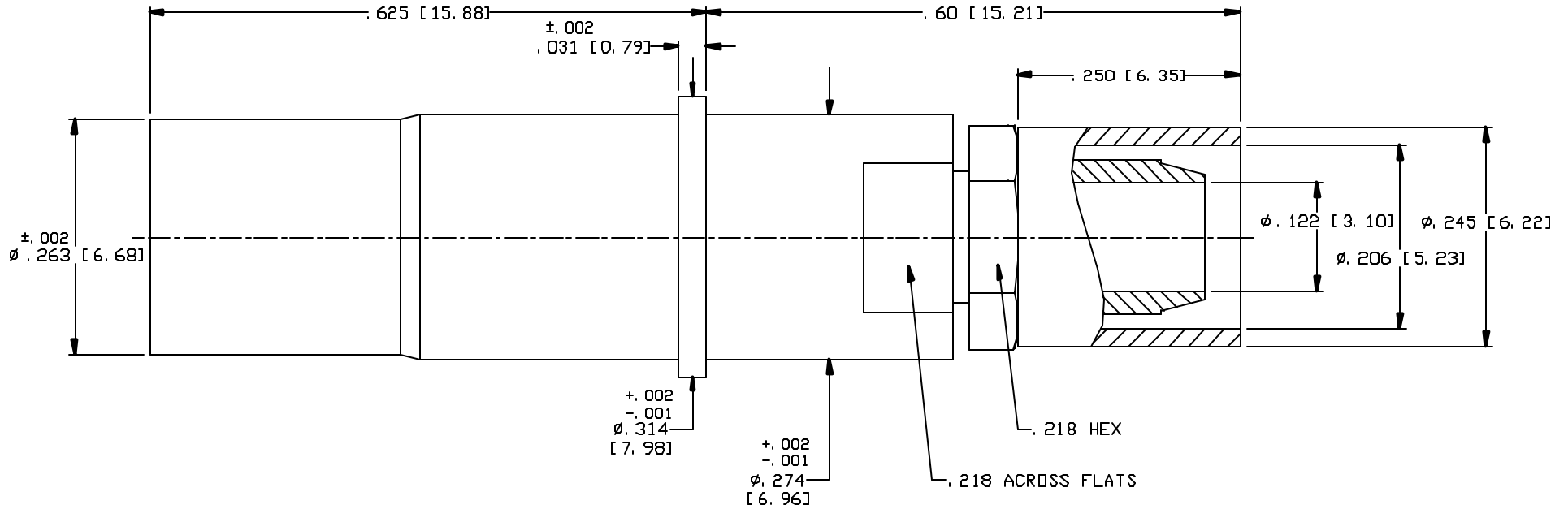

NOTES:

1. DESIGN AND INTERFACE PER I. D. S. -78.
2. DESIGN TO FIT MIL-C-38999 SERIES I, III & IV, (SIZE 8 CAVITY).
3. CRIMP NUT & FERRULE SHIPPED LOOSE.
4. ACCOMMODATES SF-142B OR SIMILAR CABLES.
5. CRIMP USING .213 HEX DIE (M22520/5-05).

				<p>PALCO CONNECTOR</p> <p>22 GREAT HILL RD., NAUGATUCK, CT 06770</p> <p>UNLESS OTHERWISE SPECIFIED, PALCO WORKMANSHIP STANDARDS APPLY</p> <p>TOLERANCES ON: DECIMALS: XX ± .01 .XXX ± .005 ANGLES ±1/2° 32'</p> <p>DIMENSIONS IN INCHES OR (METRIC) DO NOT SCALE PRINTS</p>	DRAWN YT	CHECKED HN	ENGINEER YT	APPROVED HN	FSCM 58167
C	PER ECN 11581	02/13/13	JEM		DESCRIPTION PKZ RECEPTACLE CRIMP/CLAMP TYPE				
B	PER ECN 9679	12/08/08	JEM						
A	REL. ECN 5496	06/08/00	HN		DATE 06/08/00	DRAWING NO. 78-1080-2202	PLATING OPT. A, B, C, D		
REV.	DESCRIPTION	DATE	APPR.	EPR 662					

THE INFORMATION IN THIS DOCUMENT IS CONFIDENTIAL AND PROPRIETARY AND MAY NOT BE USED FOR ANY PURPOSE WITHOUT THE WRITTEN CONSENT OF PALCO.

CABLE ASSEMBLY PROCEDURE			REV	DESCRIPTION	DATE	APPR
P/N 78-1080-2202			A	REL. ECN 5496	06/08/00	HN
PAGE 1 OF 1	DATE: 06/08/00		B	PER ECN 9679	12/08/08	JEM
DRAWN: YT	APPROVED: HN		C	PER ECN 11581	02/13/13	JEM
FOR USE WITH SF-142B CABLE		22 GREAT HILL ROAD, NAUGATUCK, CT. 06770				
		PHONE: (203) 729-9090		FAX: (203) 723-1794		

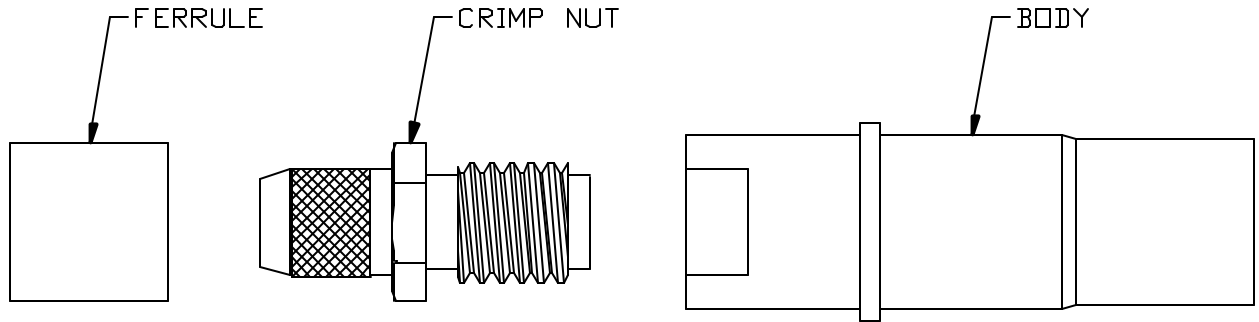

STEP 1
STRIP CABLE TO DIMENSIONS SHOWN, POINT CENTER CONDUCTOR.

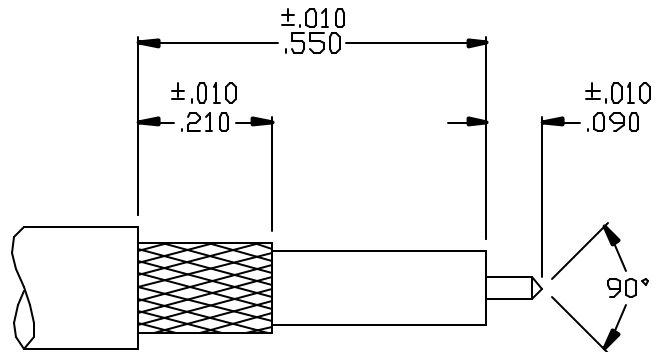

STEP 2
SLIDE FERRULE OVER CABLE. LIFT UP OUTER BRAID, DO NOT BRUSH UP THE STRANDS LONGITUDINALLY. CUT THE TAPE, BRING OUTER BRAID BACK. FLAIR INNER AND OUTER BRAID BY ROTATING DIELECTRIC.

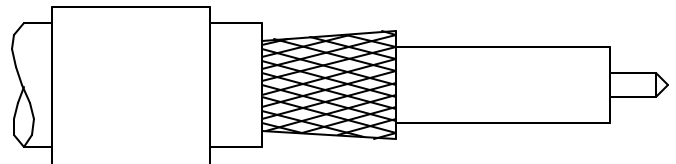

STEP 3
SLIDE CRIMP NUT OVER CABLE DIELECTRIC AND UNDER BRAID, BE SURE CRIMP NUT IS FLUSH WITH CABLE DIELECTRIC. SLIDE FERRULE UP AGAINST SHOULDER OF CRIMP NUT AND CRIMP USING .213 HEX DIE (M22520/5-05).

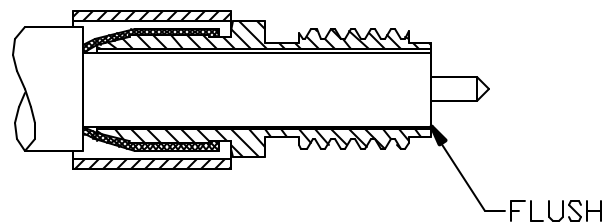

STEP 4
INSERT PREPARED CABLE ASSEMBLY INTO BACK OF BODY AND TORQUE CRIMP NUT TO 7-10 INCH-LBS.

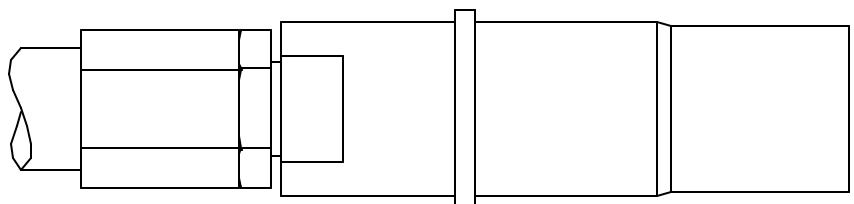

INTERFACE DESIGN STANDARD IDS-78		 22 GREAT HILL ROAD, NAUGATUCK, CT. 06770 PHONE: (203) 729-9090 FAX: (203) 723-1794	REV	DESCRIPTION	DATE	APPR
PAGE 1 OF 2	DATE: 06/16/98		B	PER ECN 5123	06/29/99	HN
DRAWN: JEM	APPROVED: HN		C	PER ECN 9935	05/22/09	JEM
			D	PER ECN 10145	01/20/10	JEM

DESCRIPTION: 78 SERIES, SIZE 8 PKZ® , FOR MIL-C-38999

MECHANICAL

MATERIALS BODIES: PLUG BODIES - BRASS PER ASTM B 16. RECEPTACLE BODIES - BRASS PER ASTM B 16.		INSULATORS - TEFLON (PTFE) PER ASTM D 1457. RETAINING RING - BERYLLIUM COPPER PER ASTM B 196. MALE CONTACT - BERYLLIUM COPPER PER ASTM B 197. FEMALE CONTACTS - BERYLLIUM COPPER PER ASTM B 197. GROUNDING RING - BERYLLIUM COPPER PER ASTM B 196.
PLATING: GOLDE PER MIL-G-45204. COPPER PER MIL-C-14550. NICKEL PER QQ-N-290.		

FINISHES (ADD LETTER TO END OF PART NUMBER)

- 'A' - .000050 MIN. GOLD OVER NICKEL
- 'B' - .000030 MIN. GOLD OVER NICKEL
- 'C' - .000050 MIN. GOLD OVER COPPER
- 'D' - .000030 MIN. GOLD OVER COPPER

MATING CHARACTERISTICS

- OUTER BODIES ————— 3 LBS MAX. INSERTION.
2 OZ. MIN. WITHDRAWL.
- CENTER CONTACTS ————— 32 OZ. MAX. INSERTION.
.5 OZ. MIN. WITHDRAWL.
- HOUSING RETENTION ————— 12 LBS. MIN.
- AXIAL MATING TOLERANCE ——.090

ELECTRICALS

FREQUENCY RANGE: DC TO 32 GHz. VOLTAGE RATING STRAIGHT: 1000 VRMS. VOLTAGE RATING ANGLED: 800 VRMS. CURRENT RATING: 5 AMPS. INSULATION RESISTANCE: 2000 MEGOHMS MIN. INSERSION LOSS: .06 $\sqrt{f(\text{GHz})}$ dB	CONTACT RESISTANCE: CENTER CONTACT 5 MILLIOHMS CONTACT RESISTANCE: OUTER CONTACT 3 MILLIOHMS VSWR: 1.08 + .009(f) GHz., RG-402 CABLE. 1.15 + .02 (f) GHz., RG-174 & RG-316 CABLES. 1.15 + .01 (f) GHz., RG-142, 223, 303 & 400 CABLES.
---	--

ENVIRONMENTAL

OPERATING TEMPERATURE: -55°C to +165°C VIBRATION: MIL-STD-202, METHOD 204, TEST CONDITION D. SHOCK: MIL-STD-202, METHOD 213, TEST CONDITION I. SALT SPRAY: MIL-STD-1344, METHOD 1001, CONDITION B. DURABILITY: 500 CYCLES.	THERMAL SHOCK: MEL-STD-202, METHOD 107, TEST CONDITION B, EXCEPT HIGH TEMPERATURE SHALL BE +85°C. MOISTURE RESISTANCE: MIL-STD-202, METHOD 106. NO MEASUREMENT AT HIGH HUMIDITY. INSULATION RESISTANCE 2000 MEGOHMS AFTER HUMIDITY.
--	--

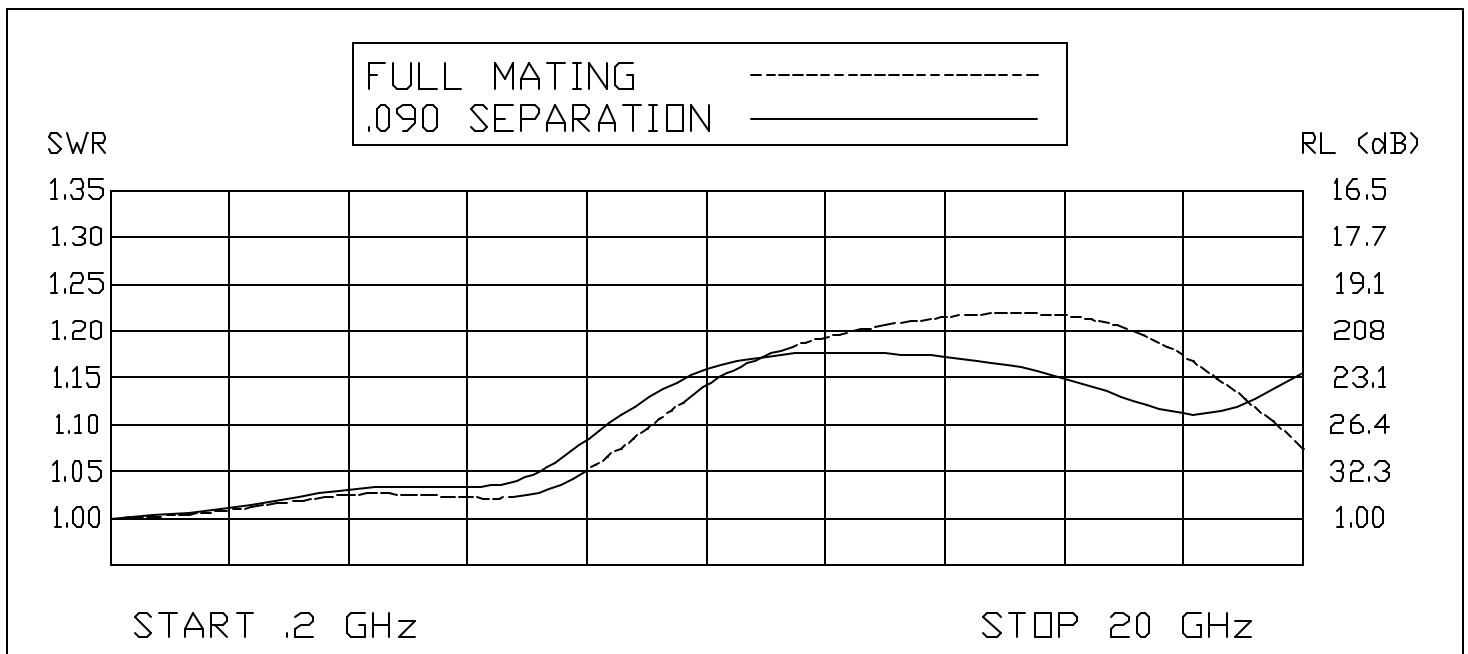

INTERFACE DESIGN STANDARD	
IDS-78	
PAGE 2 OF 2	DATE: 06/16/98
DRAWN: JEM	APPROVED: HN

PALEO
CONNECTOR

22 GREAT HILL ROAD, NAUGATUCK, CT. 06770
PHONE: (203) 729-9090 FAX: (203) 723-1794

REV	DESCRIPTION	DATE	APPR
B	PER ECN 5123	06/29/99	HN
C	PER ECN 9935	05/22/09	JEM
D	PER ECN 10145	01/20/10	JEM

DESCRIPTION: 78 SERIES, PKZ[®] SIZE 8, FOR MIL-C-38999

